

# GHH RAND®

ALCOMET BVBA  
Mosten 9 - 9160 Lokeren  
Tel.: 09 / 328 04 36 \* Fax: 09/ 328 04 93  
BTW BE 0475.222.794  
HR GENT 199.794  
Rek.nr.BE88 7374 1366 6041  
BIC: KREDBEBB



## Light Solution

The Light Solution is a simplified version, offering weight savings to the operators at highly competitive pricing, yet still containing the same high quality compressor and new generation discharge silencer, delivering improved sound attenuation.



### Versatility

- Wide air flow range from 290 to 1150 m<sup>3</sup>/hr, fulfilling industry demand
- Wide PTO input speed range that allows volume flow adjustment
- Option of direction of rotation
- Options on V-belt ratios
- CS580, CS750 and CS1200 installed within truck frame for direct drive

### Long life

- Corrosion-free rotors on the CS580, CS750, CS1050 and CS1200
- Highly durable mounting frame
- PTO and gearbox protection with use of V-belt drive; friction or shear bolt coupling available for direct driven units
- Low noise levels due to optimised belt ratios and new generation of discharge silencer
- Innovative drive configuration of CS580, CS750 and CS1200 allows for a low drive shaft angle
- Operator friendly instrumentation with maintenance display for air filter and oil pressure gauge

### Light Packages

CS580 Light  
CG600 Light  
CS700 Light  
CS750 Light  
CS1050 Light  
CS1200 Light

 **Ingersoll Rand®**

# GHH RAND®

## Scope of delivery

- V-belt drive/direct drive
- Oil free SILU® compressor
- New discharge silencer generation
- Inlet air filter
- Robust, highly durable mounting frame
- Oil pressure gauge
- Filter maintenance indicator
- Non-return and safety relief valve

## Options

- Cyclonic air filter with extended lifetime

CG600/700 Light

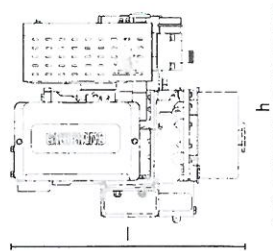

CS1050 Light

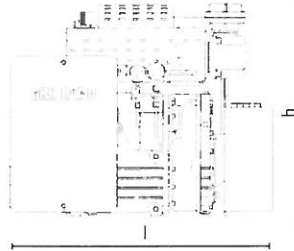

CS580/750/1200 Light

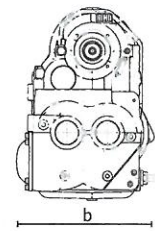
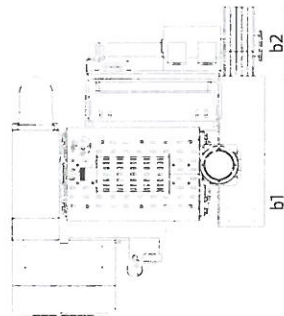
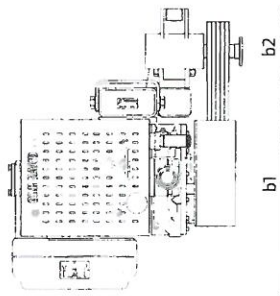
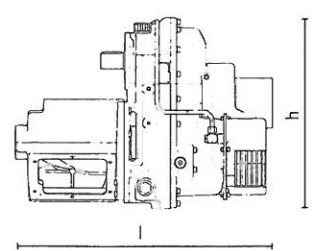

## Technical data

Parameter			CS580 L.	CG600 L.	CS700 L.	CS750 L.	CS1050 L.	CS1200 L.
Suction volume compressor airend (@ 2.0 bar(g))	min.	m³/h	421	440	290	516	435	694
	max.	m³/h	569	560	720	744	1000	1150
Input speed package	min.	min <sup>-1</sup>	1450	1340	800	1350	800	1200
	max.	min <sup>-1</sup>	1800	1600	1600	1800	1600	1800
V-belt drive ratio		i =	Direct drive	2.24	1.25	Direct drive	1.25	Direct drive
Compressor speed	min.	min <sup>-1</sup>	s.a.	3000	1000	s.a.	1000	s.a.
	max.	min <sup>-1</sup>	s.a.	3600	2000	s.a.	2000	s.a.
Power consumption	max.	kW	39	38	48	49	64	72
Dimensions	length l	mm	494**/602*	650	770	494**/602*	835	657*
	width b1+b2	mm	302*	650 + (255-365) variable	650 + (270-380) variable	302*	760 + (250-350) variable	324*
	height h	mm	430*	685	665	430*	725	485*
Weight		kg	112*	230	252	112*	308	135*

Medium: air, suction temperature: 20°C, suction pressure: 1 bar (abs.)

**GHH RAND Schraubenkompressoren GmbH**  
**Customer Center Tanker Solutions**  
 Max-Planck-Ring 27 • 46049 Oberhausen • Germany  
 Phone +49 (0) 208 9994-0 • Fax +49 (0) 208 9994-179  
 tanker-solutions@ghhrand.com • www.ghhrand.com

